

**A Report of the feasibility of
establishing a Botanical Garden in the
College Premises**



Submitted by
Government Degree College
Gambhiraopet
Dist: Rajanna Sircilla.

I.Details of the College

- a. Name of the College : Government Degree college
- b. Place of the College : Gambhiraopet
- c. District : Rajanna Sircilla
- d. Whether BSc Life Sciences Offered? : Yes
- e. If Yes, Strength of Botany Students in all 3 years of UG Courses :124
- f. No. of Botany Faculty working : Regular – 01

:Con. No	Name of the faculty	Qualifications	Date of joining	Regular/ Contract
1	B. Srivalli	M.Sc, B.Ed	31/06/2016	Regular

- g. Whether the college is running in own building : Yes

II. Details of the Land Available (Colleges with own building)

a. Total extent of land available in Acres	: 4.5 Acres
b. Extent of land covered by building	: 2877.72sq.mts.
c. Extent of land used for Play ground	: 1000 sq.yards
d. Extent of land used for amenities	: 500 sq.yards

e. Net available land for establishing Botanical Garden (Max 5 Acres)	:258 sq.yards
f. Whether compound wall available	: Yes
g. If any other information	:Nil

III. Details of Water Resources

- a. Availability of Water facility : Yes
- b. Bore well facility : Yes
- c. Mission Bhageeratha : No
- d. Water Sump Availability : Yes
- e. Whether Water facility reaches the location proposed location for botanical garden

IV. NSS Units

- a. NSS Units in the college : 01
- b. Students enrolled for NSS : 50
- c. Is there any eco club in college : Yes
- d. If yes, details of Coordinator : Smt B. srivalli
Asst. Professor of Botany
- e. No. of Student Volunteers : 50

V. Sketch for development of garden

- a. Map showing the location ear marked for I the development of botanical garden : Enclosed Annexure
- b. Plan for development : Enclosed Annexure II

c. List of Species planned and where to procure: Enclosed Annexure III

d. Essential/Critical Expenditure if any : Enclosed Annexure IV

The information regarding the above mentioned items should be prepared in separate sheets each and submitted

as enclosures.

Annexure - 1

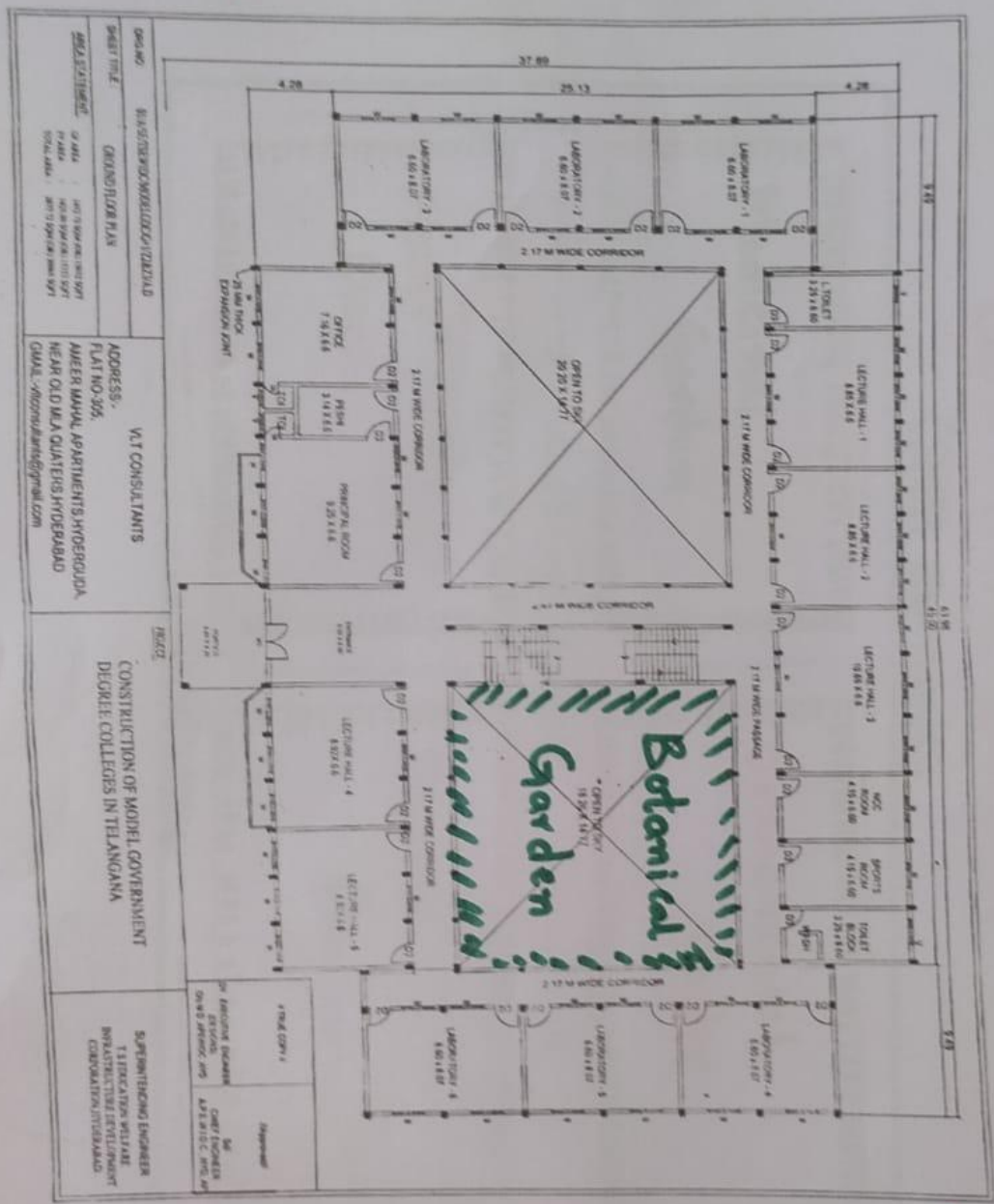

Main Road

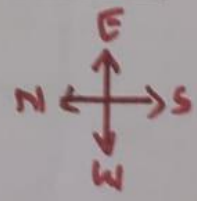

PRINCIPAL
 GOVT. DEGREE COLLEGE
 GAMBHIRAOPET-505304
 RAJAN... INSTITUTE

DRG. NO.	RAJAN.../.../...
SHEET TITLE	GROUND FLOOR PLAN
SCALE	1:100
DATE	...
DRAWN BY	...
CHECKED BY	...
APPROVED BY	...

VT CONSULTANTS
 FLAT NO-505,
 ANEER MAHA APARTMENTS HYDERABAD
 NEAR OLD MA QUAETERS HYDERABAD
 GMAIL: vtconsultants@gmail.com

FIELD
 CONSTRUCTION OF MOHEL GOVERNMENT
 DEGREE COLLEGE IN TELANGANA

SUPERINTENDING ENGINEER
 EDUCATION WELFARE
 BRANDESTRICT DEVELOPMENT
 CORPORATION HYDERABAD

Annexure-II

BOTANICAL GARDEN (258 Sq.Yards)

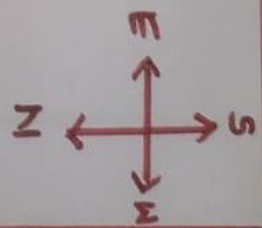
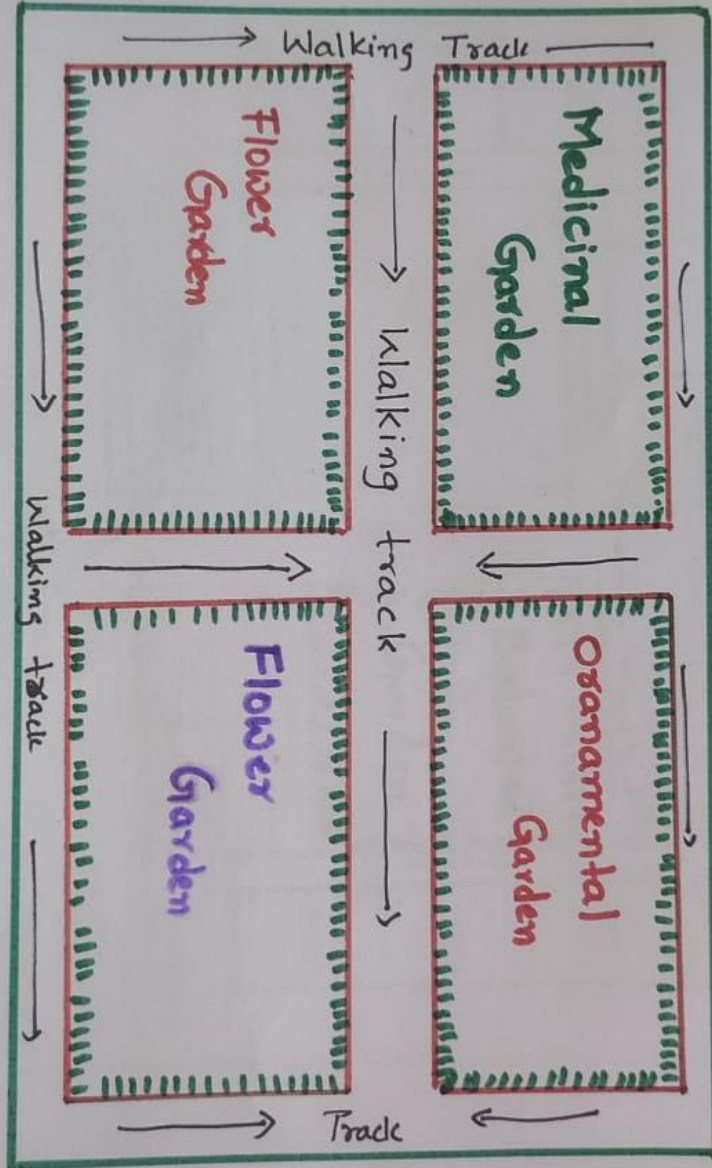

Principia
GOVT. DEGREE COLLEGE
GAMBHIRAOPET-505304
RAJANNA, S.P.

Annexure-III- List of Plants

SNO	NAME OF THE PLANT	COMMON NAME	HABIT	FAMILY	QTY
1	Chamaedorea Elegans	Parlor Palm	Tree	Arecaeae	77
2	Cordyline Red	Red Star	herb	Lily Family	15
3	Coffee bean Plant	Arabica coffee	shrub	Rubiaceae	4
4	Canna Indica	Metta Tamara	herb	Cannaceae	
5	Turnera duffusa	Damina	herb	Passifloraceae	8
6	Alpinia Nutans	Variiegata	herb	Zigeiberaceae	20
7	Swietenia humilis	Mahogany	shrub	Meliaceae	10
8	Garden carton codiaeum variegatum	Garden Lorton	herb	Euphorbiaceae	2
9	Kalanchoe Pinnata	Miracle leaf	herb	Crassulaceae	2
10	Hibiscus Sabdariffa	Hibiscus	Malvaceae	Malvaceae	21
11	Caladium bicolour	Heart of jesus	shrub	Arum/Araceae	1
12	Tradescantia spathacea	Rheodise	herb	Spider Worts	3
13	Indian sarsaparilla	Smilax ornate	herb	Apocynaceae	1
14	Asparagus densiflorus	Sprengeriferin	herb	Asparagaceae	2
15	Lemon cypress	Gold crest	shrub	Cupressaceae	1
16	Norfolk island pine	Christmass tree	tree	Araucariaceae	1
17	Psidium guajave	Guava	Tree	Myrtaceae	7
18	Salvia rosmarinus	Rosmary	shrub	Lamiaceae	1
19	Philodendron rugosum	Pig Skin	shrub	Araceae	3
20	Colocasia esculenta	Taro	shrub	Aroid family	1
21	Bauhinia Varuegata	Orchid tree	shrub	Fabaceae	1
22	Syzygium aqueum	Watery rose apple	herb	Myrtle family	1
23	Piperaceae Betel	Thamalapaku	climber	Piperaceae	2
24	Mauritius hemp	Green aloe	herb	Asparagaceae	1
25	Eucalyptus	Bluegum	Tree	Myrtaceae	6
26	Terinalia catappa	Indian almond	Tree	Combretaceae	4
27	Curio Filcoides	Blue chalk sticks	shrub	Asteraceae	1
28	Crassula ovate	Jade plant	herb	Crassulaceae	1
29	Sacred fig	Raagi	tree	Moraceae	1
30	Euphorbia milli	Crown of thorus	shrub	Euphorbiaceae	3
31	Triangle cactus	Cactus	shrub	Cactaceae	1
32	Holy Basil	Tulasi	shrub	Lamiaceae	8

33	<i>Pimenta raseмоса</i>	Bayrum	shrub	Myrtaceae	2
34	Devils Ivy	Money plant	creeper	Araceae	1
35	<i>Disanthus Cercidifolius</i>	Disanthus	shrub	Hanameladaceae	1
36	<i>Cinnamomum tamala</i>	Bagara	tree	Lauraceae	2
37	Aloe vera	Kalabanda	Tree	Asphodelaceae	10
38	<i>Annona squamosa</i>	Sitaphul	Tree	Annonaceae	1
39	<i>Chamaecostuis cuspidatus</i>	Insulin plant/spiral flag	Herb	Annobaceae	1
40	<i>Cleome viscosa</i>	Kukkavaminta	Herb	Capparidaceae	4
41	<i>Murrayakoenigii</i>	Curry leaves	Shrub	Rutaceae	2
42	<i>Citrus auruntifolia</i>	Citrus	Shrub	Rutaceae	4
43	<i>Mentha arvensis</i>	Pudina	Herb	Lamiaceae	4
44	<i>Tephrosiapurpurea</i>	Vempali	Herb	Fabaceae	2
45	<i>Mentha Piperita</i>	Mouthwash plant	Herb/Shrub	Fabaceae	4
46	<i>Pongamiapinnata</i>	Kanuga	Tree	Acanthaceae	4
47	<i>Crossandra infundubuliformis</i>	Kanakambaram	Shrub	Rosaceae	10
48	<i>Roas indica</i>	Rose	Shrub	Oleaceae	20
49	<i>Jasminum sambac</i>	Malli	Shrub	Caesalpinoideae	10
50	Palmt	Palm	Tree	Musaceae	1
51	<i>Musa paradisiacal</i>	Banana	Tree	Caesalpinoideae	5
52	<i>Coccinea cordifolia</i>	Donda	Climber	Cucurbitaceae	1
53	<i>Spathiphykkum cochlearispathum</i>	Peace lilly	Herb	Araceae	1
54	<i>Coriandrum sativum</i>	Kothimir	Herb	Apiaceae	4
55	<i>Trachyspermumamme</i>	Vamu	Herb	Apiaceae	10
56	<i>Artemesia nilagirica</i>	Dhavanam	Herb	Asteraceae	4
57	<i>Chrysanthemum indica</i>	Chamanthi	Herb	Asteraceae	2
58	<i>Tagetus petula</i>	Banti	Herb	Asteraceae	10
59	<i>Coleus blumei</i>	Coleus	Herb	Lamiaceae	12
60	<i>Leucas aspera</i>	Tummi	Herb	Lamiaceae	2
61	<i>Mentha arvensis</i>	Mentha	Herb	Lamiaceae	2

All the above plants can be procured from various Nurseries, agricultural university, horticultural university, horticultural wing at Public gardens etc

Annexure- IV- Essential/Critical Expenditure

For the establishment of New Botanical Garden at Government Degree college Gambhiraopet the following essential expenditure is needed.(Approximate Estimation)

S.No	Item Required	Amount
1	Gardening Tools	1,000
2.	Motor For Water Facility	3,000
15.	For purchase of watering pipes cans,other equipment	5,000
6	For procurement Plants	10,000
7	For purchase of manure, essential Macro,Micro Nutirents	5,000
	Total Amount Estimated	25,000 (Rs. Twenty five thousand Only)