

SHEET TITLE: GROUND FLOOR PLAN  
 AREA STATEMENT:  
 GR AREA: 1452.71 SQM (001) 1360.50 SQFT  
 TR AREA: 1462.06 SQM (001) 1553.50 SQFT  
 TOTAL AREA: 2914.77 SQM (002) 3114.00 SQFT  
 ADDRESS: VLT CONSULTANTS  
 FLAT NO-305,  
 AMEER MAHAL APARTMENTS, HYDERGUDA  
 NEAR OLD MILA QUATERS, HYDERABAD  
 GMAIL: vltconsultants@gmail.com

PROJECT: CONSTRUCTION OF MODEL GOVERNMENT  
 DEGREE COLLEGES IN TELANGANA  
 SUPERINTENDENT: T S EDUCATIONAL INFRASTRUCTURE CORPORATION  
 EXECUTIVE ENGINEER (DESIGN): QUMAD AGENCYS HYD

Mr. Chandrababu Naidu  
 Hon. Chief Minister  
 Hyderabad

296354 + 269762 568-05

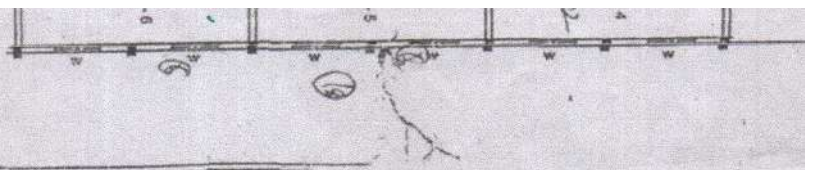

Approved

Sr.  
CHIEF ENGINEER  
A.P.E.W.I.D.C. LTD. AP

ENGINEER  
FOR THE DEVELOPMENT  
OF HYDRAULIC

